

# designPH Masterclass

Master using the designPH plugin for SketchUp. A step-by-step online course to design Passive House and Low Energy buildings using designPH

## Course Objectives

- Create a 3D model of a building in Sketchup
- Learn to use SketchUp, optimize your workflow, and use shortcuts
- Determine key building characteristics, including building envelope areas, TFA, unheated volumes, and shading elements
- Learn how to use the designPH interface and work with all functionalities of the plugin
- Assign properties and components to the 3D model
- Calculate a simplified annual energy balance for the building
- Learn how to compare design options and iteratively refine the model to achieve the Passive House criteria
- Understand the proper organization of the designPH models to streamline the workflow and minimize the potential errors
- Export the 3D model from designPH and import it into PHPP
- Learn how to refine and finalize the imported model in PHPP and use it for certification
- Gain practical experience in completing a designPH model for a single-family house

## Self-paced course

Starts the moment you enroll and you will get lifetime access to the lecture material

## Course duration

6+ hours lectures and  
around 5 hours needed to complete the exercises

## Instructors

Svetlin Dobrevski - Passive House Certifier and Trainer, CPHC  
Anton Dobrevski - Passive House Trainer, CPHC, LEED Green Associate

## Pre-requisites

- Certified Passive House Designer / Consultant online course (recommended)
- Basic understanding of PHPP

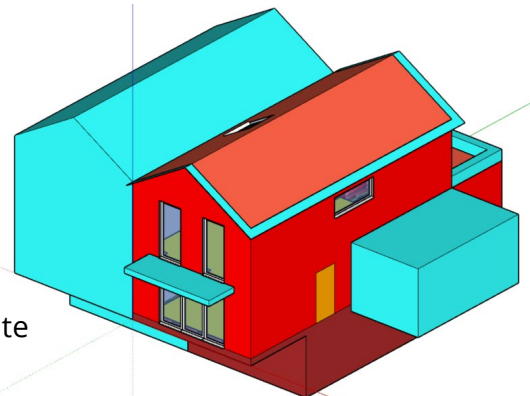

[CLICK HERE TO LEARN MORE](#)