

[Professional Development](https://calendar.aiany.org/category/professional-development/) (<https://calendar.aiany.org/category/professional-development/>), [Workshop](https://calendar.aiany.org/category/workshop/) (<https://calendar.aiany.org/category/workshop/>)

Search  (<https://calendar.aiany.org>)

Thermal Bridge Modeling for Architects: Ground Contact and Condensation Risk

Feb 21, 2020

[+ Add to Calendar](#)

Thermal bridging from concrete or metal elements such as steel studs or concrete balconies can significantly reduce the effectiveness of insulation, create cold surfaces where mold can grow, and can significantly reduce the lifespan of finishes. In high performance buildings in particular the mitigation of thermal bridges is vital and primarily the responsibility of the architectural team.

Increasingly, building codes are also requiring that designers incorporate a quantification of these thermal bridges into their energy modeling and accounting when seeking approvals. Understanding thermal bridges and their effects is fast becoming a critical skill for any designer working on the building envelope.

This half-day session will build on the concepts covered in [Thermal Bridge Modeling for Architects Part 1](https://calendar.aiany.org/2019/09/11/thermal-bridge-modeling-for-architects/) (<https://calendar.aiany.org/2019/09/11/thermal-bridge-modeling-for-architects/>). All participants should have a working knowledge of the THERM program and have THERM successfully installed on their computers if they wish to follow along in class. This class will

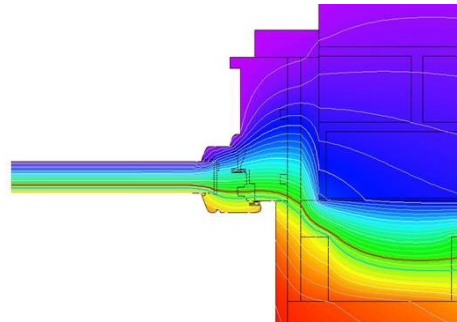

Image: Building-Type, LLC

Friday, 2/21, 1pm - 5pm

Location

Building Energy Exchange, 31 Chambers Street, Suite 609, New York, NY 10007

Price

Calendar

focus on the use of THERM to calculate ground-contact Psi-Values, and the use of THERM to calculate condensation risk factors (fRsi).

Member: \$75
General Public: \$75

Speaker:

Ed May, LEED Green Associate, Partner, BUILDING-TYPE, LLC

Other workshops in this series:

10/25/2019 – Thermal Bridge Modeling for Architects

(<https://calendar.aiany.org/2019/09/11/thermal-bridge-modeling-for-architects/>)

01/24/2020 – Thermal Bridge Modeling for Architects: Psi Values

(<https://calendar.aiany.org/2020/01/03/thermal-bridge-modeling-for-architects-psi-values/>)

–

Please Note: Your registration for this event constitutes your agreement to specific and limited use of your email address, and possibly your image or voice, in related communications. Learn more in our [Privacy Policy and Terms of Use](#)

(<https://www.aiany.org/privacy-policy/>). Contact info@aiany.org

(<https://mail.google.com/mail/?view=cm&fs=1&tf=1&to=info@aiany.org>) with questions.

(<https://mail.google.com/mail/?view=cm&fs=1&tf=1&to=info@aiany.org>) with questions.

As a reminder, AIA National policy requires participants to attend the entire educational portion of an event to receive continuing education credits. We encourage all participants to arrive on time to comply with this policy.

Organized by

AIANY Committee on the Environment; Building Energy Exchange (BE-Ex)



(<https://be-exchange.org/>)

building
energy
exchange

REGISTER

([HTTPS://AIANY-](https://aiany-community.force.com/community/evt_quickevent?ID=A0B4N00002RTVYA)

[COMMUNITY.FORCE.COM/COMMUNITY/EVT_QUICKEVENT?](https://aiany-community.force.com/community/evt_quickevent?ID=A0B4N00002RTVYA)

[ID=A0B4N00002RTVYA](https://aiany-community.force.com/community/evt_quickevent?ID=A0B4N00002RTVYA))



(<https://calendar.aiany.org/2019/09/11/thermal-bridge-modeling-for-architects/>)

New

York

Chapte

=



Therma

(<https://calendar.aiany.org/2019/09/11/thermal-bridge-modeling-for-architects-psi-values/>)



mini=the

(<https://calendar.aiany.org/2019/09/11/thermal-bridge-modeling-for-architects-psi-values/>)

u=https://www.aiaa.org/2019/09/11/thermal-bridge-modeling-for-architects-psi-values/

bridgebridgefor- Ground

modelingdelinghitecsta

for- for- groundand

architectarchitecta

groundground- Risk&b

contactcontactcondensation

and- and- risk/&title=Th

condensationbridge

risk/&title=Thermal

BridgeBridgefor bridge-

ModelModelArchitects

for for Groundfor-

ArchitectArchitectarchite

GroundGround ground

ContaContaCondensation

and and Risk&source=

CondeCondensationconden

Risk&Risk&title= risk/)

Save The Date



Calendar



<https://calendar.aiany.org/>

Jan 22, 2020

[2020 AIANY Design Awards Announcement](https://calendar.aiany.org/2019/12/20/2020-aiany-design-awards-announcement/)

[\(https://calendar.aiany.org/2019/12/20/2020-aiany-design-awards-announcement/\)](https://calendar.aiany.org/2019/12/20/2020-aiany-design-awards-announcement/)

[New Fellow Salon with Melissa DeVecchio, FAIA](https://calendar.aiany.org/2019/12/06/new-fellow-salon-with-melissa-delvecchio-faia/)

[\(https://calendar.aiany.org/2019/12/06/new-fellow-salon-with-melissa-delvecchio-faia/\)](https://calendar.aiany.org/2019/12/06/new-fellow-salon-with-melissa-delvecchio-faia/)

Jan 27, 2020

[Exhibition Design as Social Practice](https://calendar.aiany.org/2019/10/22/exhibition-design-as-social-practice/)

[\(https://calendar.aiany.org/2019/10/22/exhibition-design-as-social-practice/\)](https://calendar.aiany.org/2019/10/22/exhibition-design-as-social-practice/)



[\(https://calendar.aiany.org/2019/10/22/exhibition-design-as-social-practice/\)](https://calendar.aiany.org/2019/10/22/exhibition-design-as-social-practice/)

AIA New York | Center for Architecture

536 LaGuardia Place, New York, NY 10012 (<https://goo.gl/maps/wJdWbrTwNy72>) | 212-683-0023 | info@aiany.org (<https://mail.google.com/mail/?view=cm&fs=1&tf=1&to=info@aiany.org>)

[Join](https://www.aiany.org/membership/join/) (<https://www.aiany.org/membership/join/>)

[Competitions and Grants](https://www.aiany.org/architecture/competitions-grants/)

[\(https://www.aiany.org/architecture/competitions-grants/\)](https://www.aiany.org/architecture/competitions-grants/)

[Member Directory](https://www.aiany.org/membership/member-directory/)

[\(https://www.aiany.org/membership/member-directory/\)](https://www.aiany.org/membership/member-directory/)

[directory/](https://www.aiany.org/architecture/news/)

[News](https://www.aiany.org/architecture/news/) (<https://www.aiany.org/architecture/news/>)

[Careers](https://www.aiany.org/about/careers/) (<https://www.aiany.org/about/careers/>)

[Press Releases](https://www.aiany.org/about/press-releases/)

[\(https://www.aiany.org/about/press-releases/\)](https://www.aiany.org/about/press-releases/)

[Advertising](https://www.aiany.org/advertising/) (<https://www.aiany.org/advertising/>)

[Visit](https://www.centerforarchitecture.org/visit/) (<https://www.centerforarchitecture.org/visit/>)

[Space Rentals](https://www.aiany.org/about/space-rental/)

[\(https://www.aiany.org/about/space-rental/\)](https://www.aiany.org/about/space-rental/)

[Submit Your Event](https://calendar.aiany.org/submit/)

[\(https://calendar.aiany.org/submit/\)](https://calendar.aiany.org/submit/)

[Contact](https://www.aiany.org/about/contact/) (<https://www.aiany.org/about/contact/>)



[\(https://www.facebook.com/aiany/\)](https://www.facebook.com/aiany/)

[Subscribe to Oculus](https://loif0g9ztrmru5cc1kpx6wpengine.netdna-ssl.com/content/uploads/2017/07/oculussubscriptionform_2013_1) (https://loif0g9ztrmru5cc1kpx6wpengine.netdna-ssl.com/content/uploads/2017/07/oculussubscriptionform_2013_1)

[AIA.org](http://aia.org) (<http://aia.org>)

AIA New York | Center for Architecture 2020 - 2017 © | [Privacy Policy](https://www.aiany.org/privacy-policy/) (<https://www.aiany.org/privacy-policy/>) | Site by [For Office Use Only](http://forofficeuseonly.com) (<http://forofficeuseonly.com>)